

DIN 961 (ISO 8676)**10.9**

surub cu cap hexagonal, pas fin, filetat până sub cap

natur

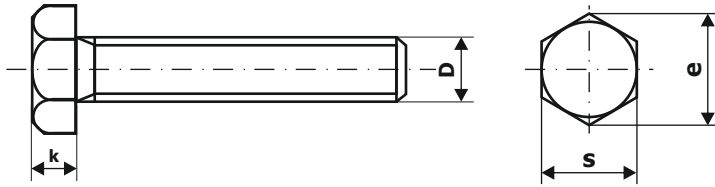

Diametru surub (mm)	8	10	12	14	16	18	20	22	24	27
s (mm)	13	17*	19*	22*	24	27	30	32*	36	41
e _{min} (mm)	14.2	17.59	19.85	22.78	26.17	29.56	32.95	37.29	39.55	45.20
k (mm)	5.3	6.4	7.5	8.8	10	11.5	12.5	14	15	12.5

* conform DIN

Cod Produs	Dimensiune (mm)	Cant./Cut. (buc)
10009611008100160	8x1x16	200
10009611008100200	8x1x20	200
10009611008100250	8x1x25	200
10009611008100300	8x1x30	200
10009611008100350	8x1x35	200
10009611008100400	8x1x40	200
10009611008100450	8x1x45	200
10009611008100500	8x1x50	200
10009611008100550	8x1x55	200
10009611008100600	8x1x60	200
10009611008100700	8x1x70	200
10009611008100800	8x1x80	200
10009611010100200	10x1x20	200
10009611010100300	10x1x30	200
10009611010100400	10x1x40	100
10009611010100500	10x1x50	100
10009611010120200	10x1.25x20	200
10009611010120220	10x1.25x22	200
10009611010120250	10x1.25x25	200
10009611010120300	10x1.25x30	200
10009611010120350	10x1.25x35	100
10009611010120400	10x1.25x40	100
10009611010120450	10x1.25x45	100
10009611010120500	10x1.25x50	100
10009611010120550	10x1.25x55	100
10009611010120600	10x1.25x60	100
10009611010120700	10x1.25x70	100

Cod Produs	Dimensiune (mm)	Cant./Cut. (buc)
10009611010120800	10x1.25x80	100
10009611010120900	10x1.25x90	100
10009611010121000	10x1.25x100	100
10009611012120160	12x1.25x16	100
10009611012120180	12x1.25x18	100
10009611012120200	12x1.25x20	100
10009611012120220	12x1.25x22	100
10009611012120250	12x1.25x25	100
10009611012120280	12x1.25x28	100
10009611012120300	12x1.25x30	100
10009611012120350	12x1.25x35	100
10009611012120400	12x1.25x40	100
10009611012120450	12x1.25x45	100
10009611012120500	12x1.25x50	100
10009611012120550	12x1.25x55	100
10009611012120600	12x1.25x60	100
10009611012120700	12x1.25x70	50
10009611012120800	12x1.25x80	50
10009611012120900	12x1.25x90	50
10009611012121000	12x1.25x100	50
10009611012150200	12x1.5x20	100
10009611012150250	12x1.5x25	100
10009611012150300	12x1.5x30	100
10009611012150350	12x1.5x35	100
10009611012150400	12x1.5x40	100
10009611012150450	12x1.5x45	100
10009611012150500	12x1.5x50	100

DIN 961 (ISO 8676)**10.9**

surub cu cap hexagonal, pas fin, filetat până sub cap

natur

Cod Produs	Dimensiune (mm)	Cant./Cut. (buc)
10009611012150600	12x1.5x60	100
10009611012150700	12x1.5x70	50
10009611012150800	12x1.5x80	50
10009611012150900	12x1.5x90	50
10009611014150250	14x1.5x25	100
10009611014150300	14x1.5x30	100
10009611014150350	14x1.5x35	100
10009611014150400	14x1.5x40	100
10009611014150450	14x1.5x45	50
10009611014150500	14x1.5x50	50
10009611014150550	14x1.5x55	50
10009611014150600	14x1.5x60	50
10009611014150700	14x1.5x70	50
10009611014150800	14x1.5x80	50
10009611014150900	14x1.5x90	50
10009611016150250	16x1.5x25	50
10009611016150300	16x1.5x30	50
10009611016150350	16x1.5x35	50
10009611016150400	16x1.5x40	50
10009611016150450	16x1.5x45	50
10009611016150500	16x1.5x50	50
10009611016150550	16x1.5x55	50
10009611016150600	16x1.5x60	50
10009611016150650	16x1.5x65	25
10009611016150700	16x1.5x70	25
10009611016150800	16x1.5x80	25
10009611016150900	16x1.5x90	25
10009611016151000	16x1.5x100	25
10009611016151100	16x1.5x110	25
10009611018150300	18x1.5x30	50
10009611018150350	18x1.5x35	50
10009611018150400	18x1.5x40	50
10009611018150450	18x1.5x45	50
10009611018150500	18x1.5x50	50
10009611018150550	18x1.5x55	25
10009611018150600	18x1.5x60	25
10009611018150700	18x1.5x70	25
10009611018150800	18x1.5x80	25

Cod Produs	Dimensiune (mm)	Cant./Cut. (buc)
10009611018150900	18x1.5x90	25
10009611020150300	20x1.5x30	25
10009611020150350	20x1.5x35	25
10009611020150400	20x1.5x40	25
10009611020150450	20x1.5x45	25
10009611020150500	20x1.5x50	25
10009611020150550	20x1.5x55	25
10009611020150600	20x1.5x60	25
10009611020150650	20x1.5x65	25
10009611020150700	20x1.5x70	25
10009611020150750	20x1.5x75	25
10009611020150800	20x1.5x80	25
10009611020150900	20x1.5x90	25
10009611020151000	20x1.5x100	25
10009611022150400	22x1.5x40	25
10009611022150450	22x1.5x45	25
10009611022150500	22x1.5x50	25
10009611022150550	22x1.5x55	25
10009611022150600	22x1.5x60	25
10009611022150650	22x1.5x65	25
10009611022150700	22x1.5x70	25
10009611022150800	22x1.5x80	25
10009611024150900	24x1.5x90	10
10009611024200500	24x2x50	25
10009611024200550	24x2x55	25
10009611024200600	24x2x60	25
10009611024200650	24x2x65	25
10009611024200700	24x2x70	25
10009611024200750	24x2x75	25
10009611024200800	24x2x80	10
10009611024200900	24x2x90	10
10009611024201000	24x2x100	10
10009611024201200	24x2x120	10
10009611027200500	27x2x50	25
10009611027200550	27x2x55	15
10009611027200600	27x2x60	15
10009611027200650	27x2x65	15

- ▶ Datele de ambalare au doar scop informativ și pot să difere după caz.
- ▶ Pentru mărimile care nu sunt prezentate în tabelul nostru, contactați departamentul de servicii clienți.
- ▶ Toate datele sunt exclusiv informative, nu ne asumăm răspunderea pentru eventualele greșeli.